

# HITACHI ELECTROMAGNETIC CONTACTOR

Type	Rated insulation voltage (Ui)	Max. rated capacity of motor			Rated thermal current (AC1 = Ith)	Applicable standard	Aux. Contact	Weight
H12-R	AC 660 V	240V	3kW	12A	20 A	IEC 60947-4-1	2a1b x2	0.79 kg
		440V	4kW	9A			1a2b x2	

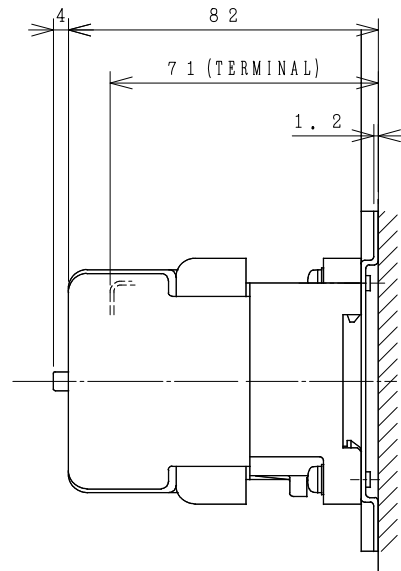
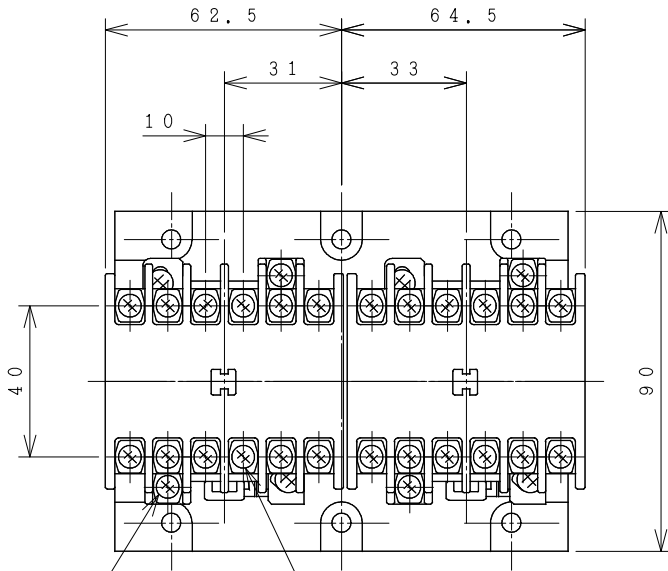

OUTLINE DIMENSIONS.

TERMINAL  
M3.5 SCREW  
(W=7.8)

COIL TERMINAL  
M3.5 SCREW  
(W=7.8)

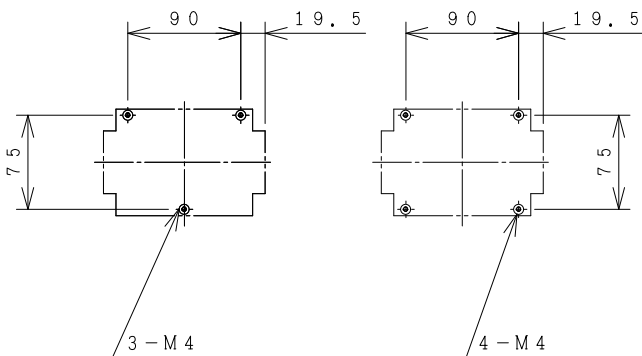

MOUNTING HOLES.

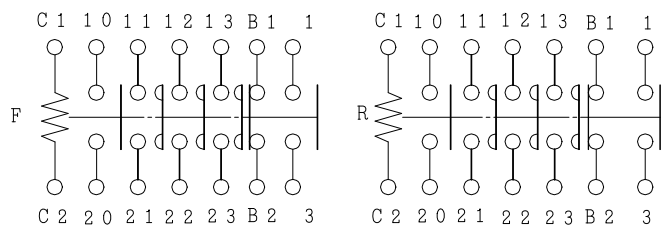

CONTACTS ARRANGEMENT.

(Reference 43043435R02).

※REMARK

- DIMENSION UNIT = Millimeter (mm).
- (a) = AUX. CONTACT NORMALLY OPENED.
- (b) = AUX. CONTACT NORMALLY CLOSED.

DWN. C. JERRANAN	10/09/16	PROJECTION	TITLE
CHKD. <i>Jan-a</i>	S	SCALE NTS.	DIMENSION OF H12-R
APPD. <i>C. Kiattisak</i>			
<b>HITACHI</b> Hitachi Industrial Technology (Thailand), Ltd.			REV.
			00
4HTN000852			SH.
			01
			01

(W=) : WIDTH OF TERMINAL.