

HITACHI ELECTROMAGNETIC CONTACTOR

| Type | Rated insulation voltage (Ui) | Max. rated capacity of motor | | | Rated thermal current (AC1 = Ith) | Applicable standard | Aux. Contact | Weight |
|---------|-------------------------------|------------------------------|-------|------|-----------------------------------|---------------------|--------------|-----------|
| H400C-G | AC 660 V | 240V | 115kW | 400A | 420 A | IEC 60947-4-1 | (3a3b) x 2 | 9.7 kg |
| | | 440V | 200kW | 400A | | | | |

*WITH AUX. CONTACT (4 a 4 b) x 2 = 199 mm.

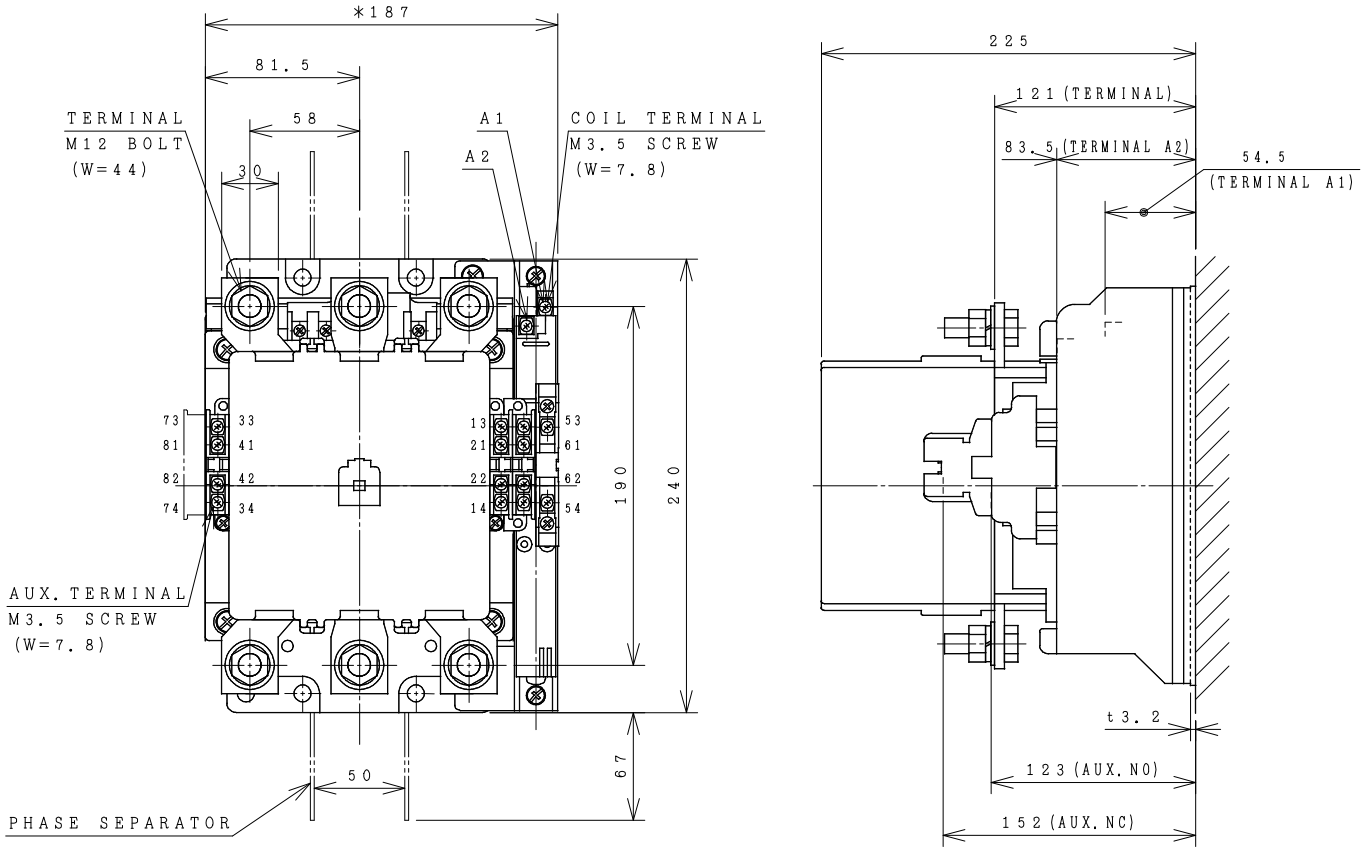

OUTLINE DIMENSIONS.

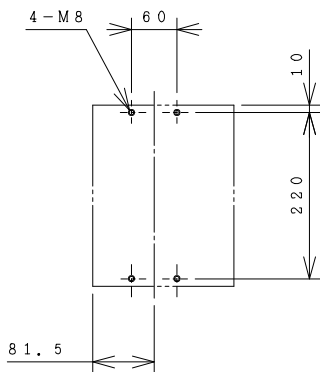

MOUNTING HOLES.

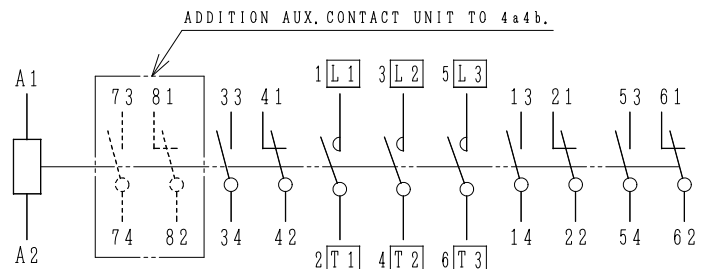

CONTACTS ARRANGEMENT.

(Reference 43057720R01).

| | | | |
|--|------------|-------------------------|------|
| DWN. S. CHAIAMPOL 02/09/16 | PROJECTION | TITLE | REV. |
| CHKD. <i>ims-a</i> | SCALE | DIMENSION OF H400C-G | 00 |
| APPD. <i>C.Kiattisak</i> | NTS. | | 01 |
| | | HITT WORKS DWG. No. | 01 |
| HITACHI Hitachi Industrial Technology (Thailand), Ltd. | | 4HTN000933 | |

(W=) : WIDTH OF TERMINAL.

*REMARK

- DIMENSION UNIT = Millimeter (mm.).
- (a) = AUX. CONTACT NORMALLY OPENED.
- (b) = AUX. CONTACT NORMALLY CLOSED.